

Volvo EC750 Bucket for Volvo Excavator

| Model | Vol vo EC750D | Vol vo EC750CN4 | Vol vo EC750CN4 |
|------------------------|---------------------------|-----------------|-----------------|
| Operating weight | 72700 - 74700 kg | 75200 kg | 100945 kg |
| Bucket capacity | 3.3 - 5.16 m ³ | 3.3 - 5.16 m | 3.3 - 5.16 m |
| Digging force | 325 kN | 323 kN | 383 kN |
| Maximum digging depth | 7210 mm | 7210 mm | 7210 mm |
| Maximum digging radius | 11460 mm | 11460 mm | 11460 mm |

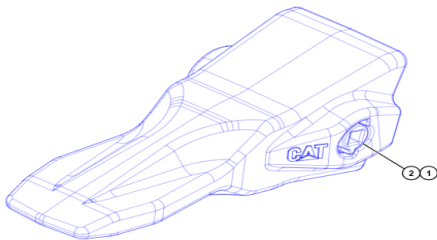

Product Details

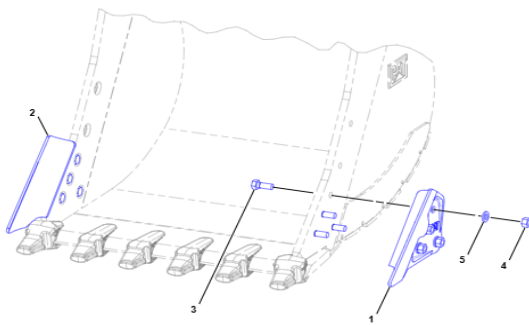

| | |
|------------------------|------------------------------------|
| Product Name | BUCKET |
| Origin | United States |
| Brand Name | STONE |
| Model | Volvo 750 |
| Price | Negotiable |
| Packing Details | Standard Export Packing |
| Delivery Time | 0-30 Days |
| Payment Term | L/C, T/T |
| Price Term | FOB, CIF, CFR |
| Supply Capacity | 50,0 PCS/Month |
| Minimum Order Quantity | 1 PC |
| Material | High strength wear-resistant steel |
| Technology | Precision Machining |
| Surface | Treatment Anti-Corrosion Coating |
| Quality | Original Factory Standard |
| After-Sales Service | Full Support, Online Service |
| Application | Excavator |

Excavator Bucket

Volvo 750

| | Heavy-duty operation | | | | | | | | | | | |
|------------------|----------------------|-----|---------|-----|----------------|------------------|----------------|------------------|----------|------|---------|-------|
| | width | | | | capacity | | | | weight | | | |
| | smallest | | maximum | | smallest | | maximum | | smallest | | maximum | |
| | m m | i n | m m | i n | m ³ | y d ³ | m ³ | y d ³ | k g | l b | k g | l b |
| Small Excavator | 450 | 18 | 1400 | 55 | 0.20 | 0.26 | 1.10 | 1.44 | 266 | 586 | 686 | 1512 |
| Wheel Excavator | 450 | 18 | 1300 | 51 | 0.20 | 0.26 | 1.07 | 1.41 | 266 | 586 | 737 | 1625 |
| Medium Excavator | 600 | 24 | 1850 | 72 | 0.44 | 0.57 | 2.40 | 3.14 | 546 | 1243 | 1909 | 4209 |
| Large Excavator | 750 | 30 | 2450 | 96 | 0.73 | 0.95 | 6.00 | 7.85 | 937 | 2065 | 5913 | 13036 |

STONE: Construction machinery parts expert in China



We are committed to providing a variety of parts including bulldozers, excavators and wheel loaders for well-known brands such as Carter and Komatsu. Our product line covers a full range of OEM parts, such as Track Chain, Track Rollers, Sprocket, Excavator Buckets, Blades, Excavator Cylinders, Swing Circles, and various electrical and hydraulic components to ensure that our customers' stringent requirements for quality and performance are met.



Stone (Shanghai) Engineering Machinery Co., Ltd. is a leading supplier of engineering machinery parts, focusing on providing high-quality parts for mining companies. Since its establishment in 2004, we have been based in Shanghai, China, and have built our own brand STONE, becoming a trusted choice in the industry.